

# Instruction Sheet

**Subject: FreshBlender Motor Shaft Alignment Tool**

**SCOPE: ALL MULTIPLEX FRESHBLENDERS**

## TOOLS REQUIRED

- 020008186 Motor Shaft Alignment Tool
- Clean Towels

Motor shaft alignment is only needed when having trouble engaging new product bag pump onto motor shaft.

## INSTRUCTION

1. Remove empty/expired product bag and bin from unit. (See Figure 1)
2. Place clean towels under bin.
3. Push down on pump latch.
4. Pull bin straight out, holding towel under pump to catch product spills, dispose of product bag, then set empty bin aside.
5. Place tool onto motor drive shaft as shown with bent part facing away from you. (See Figure 2)
6. Rotate tool counter-clockwise until back tab of tool makes contact with sanitation fitting spigot as shown. (See Figure 3)
7. Remove tool by sliding off shaft towards you without rotating shaft. One edge/tine of shaft will be aligned at top of shaft. (See Figure 3)
8. Place new product bag into bin and secure pump by snapping into bin slot. (See Figure 4)
9. Place bin with new product bag into unit making sure pump lines up with motor shaft and press firmly into place. Secure pump latch after bin is fully inserted.

NOTE: Hands covered with cut resistant gloves can be used in place of the tool to turn shaft. Turn shaft until one of the edges/tines on the shaft is aligned at top of shaft. (See Figure 3)

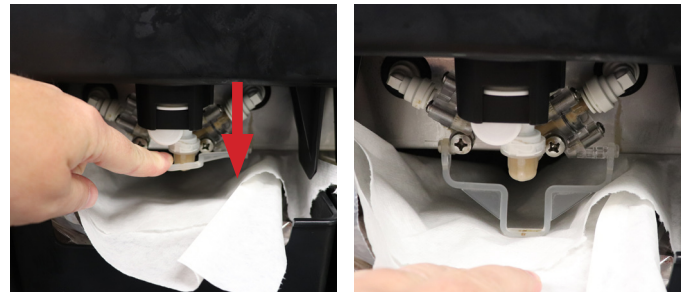

FIGURE 1 - Remove Product and Bin

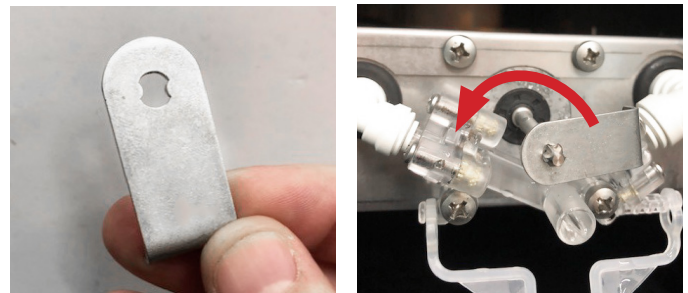

FIGURE 2 - Place Tool onto Motor Shaft

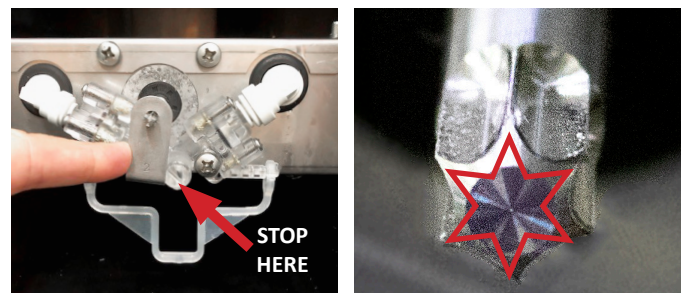

FIGURE 3 - Rotate Tool on Shaft, Remove Tool, Shaft Aligned



FIGURE 4 - Verify New Product Bag Is Installed Correctly